

NEW PROVIDENCE 5K 2008

Course Map(not to scale)

New Providence, NJ

NJ08005LMB

Expires 12/31/2018

New Providence
HS. - M.S.

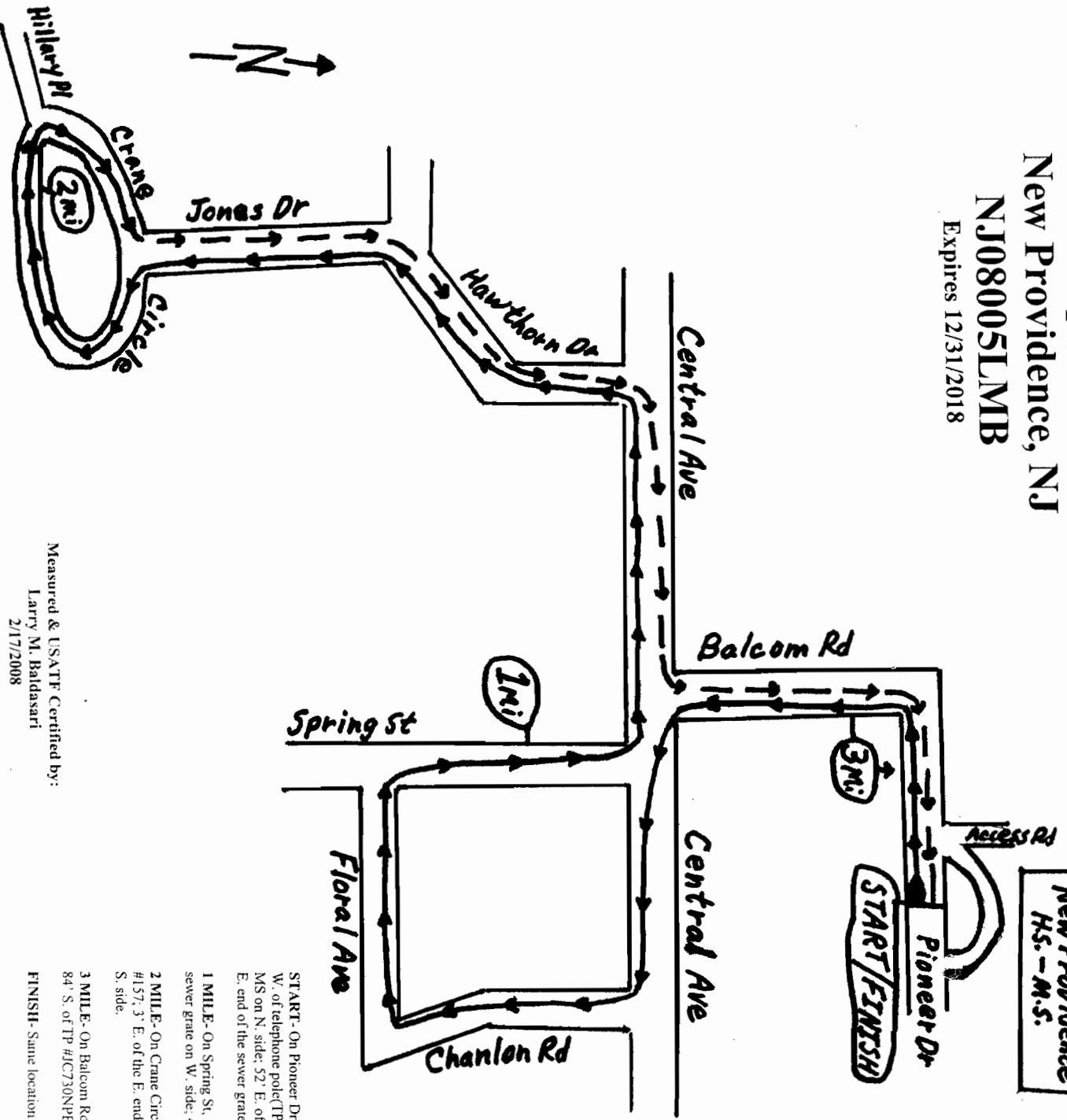

START- On Pioneer Dr, in front of New Providence High School - Middle School, 32' W. of telephone pole(TP) #BT634NPE on S. side of road; 32' W. of the sign for the HS-MS on N. side; 52' E. of the curb line extended for the school's Access Rd; 68' E. of the E. end of the sewer grate on S. side; 95' E. of TP #JC732NPE on S. side.

1 MILE- On Spring St, 11' S. of TP #JC81NPE on W. side; 2' S. of the S. end of the sewer grate on W. side; 47' N. of the fire hydrant on W. side.

2 MILE- On Crane Circle, E. of Hillary Pl and across from the front door for house #157; 3' E. of the E. end of the driveway for house #157; 31' W. of TP #BT863NPE on S. side.

3 MILE- On Balcom Rd, just S. of Pioneer Dr; 51' N. of TP #JC61013NPE on E. side; 84' S. of TP #JC730NPE on W. side.

FINISH- Same location as **START**

Measured & USATF Certified by:
Larry M. Baldasari
2/17/2008

NEW PROVIDENCE 5K 2008 - Measured Points

START- On Pioneer Dr, in front of New Providence High School – Middle School; 32' W. of telephone pole(TP) #BT634NPE on S. side of road; 32' W. of the sign for the HS-MS on N. side; 52' E. of the curb line extended for the schools' Access Rd; 68' E. of the E. end of the sewer grate on S. side; 95' E. of TP #JC732NPE on S. side.

1 MILE- On Spring St, 11' S. of TP #JC81NPE on W. side; 2' S. of the S. end of the sewer grate on W. side; 47' N. of the fire hydrant on W. side.

2 MILE- On Crane Circle, E. of Hillary Pl and across from the front door for house #157; 3' E. of the E. end of the driveway for house #157; 31' W. of TP #BT863NPE on S. side.

3 MILE- On Balcom Rd, just S. of Pioneer Dr; 51' N. of TP #JC61013NPE on E. side; 84' S. of TP #JC730NPE on W. side.

FINISH- Same location as **START**.

NEW PROVIDENCE 1 MILE FUN RUN

½ MILE TURNAROUND – On Chanlon Rd, across from the A&P parking lot; 46' S. of telephone pole #JP1230NPE on W. side; 27' N. of "NO PARKING ANY TIME" sign pole on W. side.

Note: The Fun Run **START/FINISH** are the same location as the 5K.